

Traction load cells

TR Series

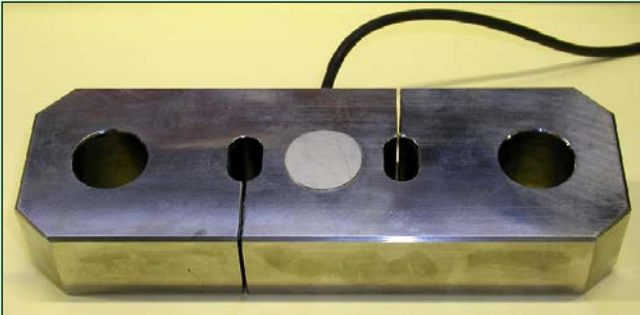

Description

- Traction load cells for OEM applications or for weighing
- Can be used with a remote display (VSM series)
- On request with integrated display (DE series)
- Normally made of steel
- Other materials available on request

The available standard models are shown in the following table:

Model	Capacity [kg]
TR 30	3000 FS
TR 65	6500 FS
TR 120	12000 FS
TR 250	25000 FS
TR 350	35000 FS

Note: The user/installer is responsible for evaluating the values and, thus, the safety of the application

Technical data

Maximum power supply	15	Vdc
Standard sensitivity	1.0	mV/V
Maximum overload ⁽¹⁾	150	% FS
Breaking load	300	% FS
Combined error	±1.0	% FS
FS and zero temperature coeff.	0.008	% FS/°C

Insulation	> 5	GΩ
Input and output resistance	700±20	Ω
Compensated temperature range	-10÷40	°C
Operating temperature	-20÷70	°C
Standard protection grade	IP67	-

⁽¹⁾ Does not modify the setting

Electrical connection: screened cable with 4 conductors, standard length L = 4 m

Dimensions [mm]

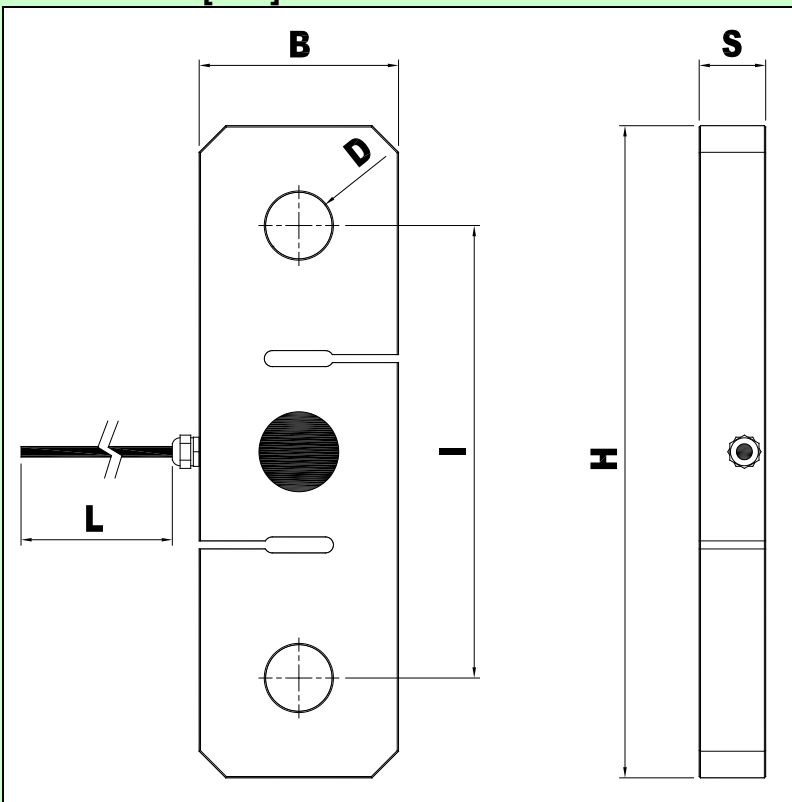

Model	H	B	I	S	D
TR 30	210	70	150	34	26
TR 65	210	70	150	34	26
TR 120	270	100	186	50	36
TR 250	360	110	226	72	52
TR 350	385	125	226	80	60